

Veeam.VMCE2021.vNov-2023.by.JackM.85q

Number: VMCE2021
Passing Score: 800.0
Time Limit: 120.0
File Version: 7.0

Exam Code: VMCE2021
Exam Name: Veeam Certified Engineer 2021



Exam A

QUESTION 1

An administrator has decided to set up a VM backup job covering their Microsoft SQL servers. What feature must be enabled to ensure quiescence of the SQL databases during the backup?

- A. Enable Microsoft SQL server plug-in.
- B. Enable application-aware processing.
- C. Enable Microsoft Windows OS processing.
- D. Enable Microsoft SQL server agent on the VMs

Correct Answer: B

Section:

Explanation:

According to the Veeam Agent for Microsoft Windows User Guide¹, you need to enable application-aware processing to ensure quiescence of the SQL databases during the backup. Application-aware processing allows Veeam Agent for Microsoft Windows to create transactionally consistent backups of SQL Server VMs.

QUESTION 2

Which feature can be used in Veeam Explorer for Oracle database?

- A. Recover from litigation and in-place hold items
- B. Restore original password for account objects
- C. Restore databases from backups created with Veeam RMAN plug-in
- D. Export to .BAK file

Correct Answer: C

Section:

Explanation:

According to the Veeam Backup Explorers Guide¹, Veeam Explorer for Oracle allows you to restore and export Oracle databases and Data Guard from backups created by Veeam Backup & Replication or Veeam Plug-in for Oracle RMAN.

QUESTION 3

A backup job is configured as follows.

Mode	Forward incremental with weekly synthetic full
Start time	Every day at 20:00
Active full	Sunday
Restore points to keep	14 restore points
Time to finish job	1 hour
Job created	Friday, 13:00

How many full and incremental restore points will be in a repository on day 16 at 23:00?

- A. 3 full and 14 incremental
- B. 2 full and 12 incremental



- C. 3 full and 15 incremental
- D. 1 full and 13 incremental

Correct Answer: B

Section:

QUESTION 4

An administrator is asked to change a backup copy job from periodic mode to immediate mode. How can this be accomplished?

- A. Edit the original job and select immediate copy mode from the job settings.
- B. Enable immediate mode on the repository.
- C. Create a new copy job and delete the original job.
- D. Modify the job settings on the proxy performing the copy job.

Correct Answer: A

Section:

Explanation:

According to the Veeam Backup & Replication User Guide¹, you can change the backup copy mode by editing backup copy job settings. However, this is only possible if the backup copy job has true per-machine backup storage format.

QUESTION 5

Veeam Agent for Linux has been installed in standalone mode on a Linux physical server. The backup job is configured to write to a Veeam repository. Which of the following media types is available as a recovery media?

- A. ISO image
- B. Veeam Backup & Replication repository
- C. Object storage
- D. Tape

Correct Answer: A

Section:

Explanation:

According to the Veeam Agent for Linux User Guide¹, Veeam Agent for Linux lets you use the Veeam Recovery Media — a recovery image of the Linux OS that provides an alternative way to boot your computer. The recovery image is an ISO file that you can burn to a CD/DVD or write to a USB flash drive.

QUESTION 6

A Scale-out Backup Repository with one local extent has been configured as follows.





 Vdumps

A daily VMware backup job retention is 31 days, keeping weekly GFS full backups for 14 weeks. It is Jan. 20. A file from a backup that occurred on Jan. 1 must be recovered. Where is the data?

- A. The archive tier
- B. The performance tier and the capacity tier
- C. The performance tier
- D. The capacity tier

Correct Answer: C

Section:

QUESTION 7

For general data protection regulation (GDPR) compliance, Veeam can add a location tag to which component?

- A. Guest interaction proxies
- B. vCenter servers
- C. Cloud gateways
- D. WAN accelerators

Correct Answer: B

Section:

Explanation:

Veeam Backup & Replication allows you to assign information about locations to the following infrastructure objects: Virtual infrastructure objects: vCenter Servers, datacenters, clusters and hosts. Backup infrastructure objects: backup repositories, external repositories, scale-out backup repositories, tape libraries and tape vaults. Agent management objects: protection groups. Veeam Cloud Connect for service providers: cloud repositories and hardware plans. <https://helpcenter.veeam.com/docs/backup/vsphere/locations.html?ver=120>

QUESTION 8

Which of the following backup types are valid for both Veeam Agent for Microsoft Windows and Veeam Agent for Linux? (Choose two.)

- A. Snapshot-level backup
- B. File-level backup
- C. Personal files backup
- D. Volume-level backup
- E. OS-level backup

Correct Answer: B, D

Section:

Explanation:

https://helpcenter.veeam.com/docs/agentforwindows/userguide/backup_job_mode.html?ver=60

QUESTION 9

A physical Linux server protected by a centrally managed Veeam agent is physically damaged. A VMware vSphere infrastructure is available, and the physical server is eligible for virtualization. Which recovery step provides the lowest possible RTO?

- A. Use restore guest files to Hyper-V VM
- B. Use bare metal restore to Hyper-V VM.
- C. Use instant disk recovery to Hyper-V VM
- D. Use Instant VM Recovery to Hyper-V VM

Correct Answer: A

Section:

Explanation:

According to the Veeam Agent for Linux User Guide¹, you can use the Restore volumes option to perform bare metal recovery of your computer. However, this option requires you to boot from the Veeam Recovery Media and may take some time to complete.

Another option is to use Instant VM Recovery to VMware vSphere. This option allows you to run your Linux computer directly from a backup file as a VMware VM without restoring any data. This can significantly reduce your RTO and provide immediate access to your applications and data.

QUESTION 10

What does Veeam's Secure Restore functionality ensure during restores?

- A. 256-bit AES encryption of in-flight data
- B. Anti-virus scanning
- C. Custom ports for in-flight data
- D. Proper rights/permissions on files and folders

Correct Answer: B

Section:



QUESTION 11

A Veeam administrator is concerned about keeping backups on site and has traditionally used tapes to store backups older than 30 days in order to free up space on their backup repository for longer term storage. The company is currently using Scale-out Backup Repositories. What option would satisfy the requirement?

- A. Copy to capacity tier
- B. Move to capacity tier
- C. Backup to object storage
- D. File copy job

Correct Answer: B

Section:

QUESTION 12

What data sources can be connected to Veeam ONE? (Choose two.)

- A. Veeam Backup & Replication servers
- B. Microsoft Hyper-V servers
- C. Veeam Backup & Replication agents
- D. Microsoft Azure VMs
- E. Amazon Web Services EC2 instances

Correct Answer: A, B

Section:

Explanation:

https://helpcenter.veeam.com/docs/one/deployment/connect_servers.html?ver=120

**QUESTION 13**

An administrator needs to configure a backup job that dynamically adds new VMware hosted SQL servers. How can this be accomplished?

- A. Create a dynamic backup job in Enterprise Manager.
- B. Create a job based on vSphere tags.
- C. Create a CSV file that is scanned before the backup job starts.
- D. Enable application aware processing.

Correct Answer: B

Section:

QUESTION 14

Veeam ONE _____ can detect when a potential ransomware attack is happening and be configured to take mitigating actions.

- A. Reporting
- B. Alert Management
- C. Alarm Management
- D. Data Protection View

Correct Answer: C

Section:

Explanation:

Veeam ONE can help notify you of suspicious activity in your datacenter through the Possible Ransomware Activity alarm. This alarm can be configured to take mitigating actions such as sending an email notification, running a script or creating a support case.

QUESTION 15

What is the default suffix added to a replica's VM name?

- A. _secondary
- B. _replica
- C. _map
- D. _seed

Correct Answer: B

Section:

QUESTION 16

In the war against ransomware, a company decided to implement tape backup for the first time. The tape library has already been added. Of the following, what must be done first?

- A. Create vaults.
- B. Create media pools.
- C. Create libraries.
- D. Create media sets.

Correct Answer: B

Section:

**QUESTION 17**

A Windows VM running on Microsoft Hyper-V is protected using the file indexing option. The guest interaction proxy is offline. Which of the following Veeam servers will be used to deploy the runtime during the backup process?

- A. Backup & Replication server
- B. Indexing database server
- C. File proxy server
- D. Virtual lab server

Correct Answer: A

Section:

Explanation:

https://helpcenter.veeam.com/archive/backup/110/hyperv/guest_interaction_proxy.html According to the Veeam Software Help Center¹, Veeam Backup & Replication deploys runtime components on a VM guest OS to perform file indexing. These components can be either nonpersistent or persistent depending on whether you have enabled application-aware processing for the VM.

If you have enabled application-aware processing for the VM, Veeam Backup & Replication uses a persistent agent component that is installed on the VM guest OS during backup job session and remains on the VM after that. In this case, if the guest interaction proxy is offline, Veeam Backup & Replication will use another available guest interaction proxy or fail over to the backup server.

If you have not enabled application-aware processing for the VM, Veeam Backup & Replication uses a non-persistent runtime component that is deployed on the fly and removed after indexing is complete. In this case, if the guest interaction proxy is offline, Veeam Backup & Replication will use another available guest interaction proxy or fail over to the backup server.

QUESTION 18

A Scale-out Backup Repository with one local extent has been configured as follows.

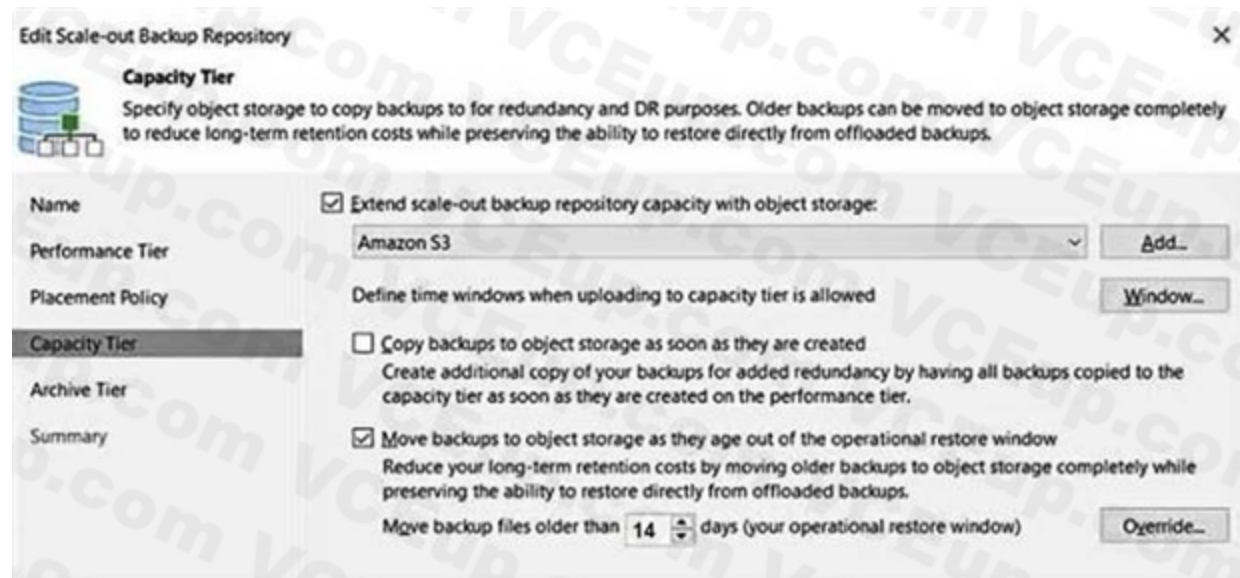

12 VMware VMs are being backed up daily by a forward incremental backup job, which has a 31-day retention, creating synthetic fulls on Saturdays. After running for more than 31 days, which of the following would be accurate?

- A. Both the performance tier and capacity tier will contain all restore points.
- B. The performance tier will contain all restore points. The capacity tier will contain zero restore points.
- C. The performance tier will contain the most recent 15 to 22 days of restore points. The capacity tier will contain the oldest 14 days of restore points.
- D. The performance tier will contain the most recent 14 to 20 days of restore points. The capacity tier will contain all restore points.

Correct Answer: C

Section:

QUESTION 19

A company needs to recover a VM from VMware very quickly. The company decides to use Instant VM Recovery from their last backup. What platforms can this backup be instantly restored to? (Choose three.)

- A. Azure
- B. Hyper-V
- C. AWS
- D. GCP
- E. AHV
- F. VMware

Correct Answer: B, E, F

Section:

QUESTION 20

A critical server in a Hyper-V environment has crashed and will not reboot. What is the fastest way to bring this server back online so employees can continue to work?

- A. Instant VM Disk Recovery
- B. Entire VM restore
- C. Instant VM Recovery
- D. Staged restore

Correct Answer: A



Section:

Explanation:

Answer: A

Explanation:

https://helpcenter.veeam.com/docs/backup/vsphere/backup_copy_path.html?ver=120

QUESTION 21

What is necessary prior to configuring replica mapping?

- A. A Veeam backup in the production site
- B. A Veeam replica in the disaster recovery site
- C. A Veeam backup in the disaster recovery site
- D. A Veeam replica in the production site

Correct Answer: B

Section:

Explanation:

https://helpcenter.veeam.com/archive/backup/110/vsphere/replica_seeding.html

QUESTION 22

A physical Linux file server needs to be migrated to VMware ESXi. The server has several volumes: /dev/sda (60GB), /dev/sdb (1TB) and /dev/sdc (4TB). What is the quickest option to migrate the server?

- A. Export all disks, create an empty VM and attach the disks.
- B. Create an empty VM and perform bare metal recovery inside the VM.
- C. Perform Instant VM Recovery.
- D. Perform Instant Disk Recovery for each volume.



Correct Answer: C

Section:

QUESTION 23

At 18:00, after a Windows update installation, a VM is stuck in an infinite boot loop. The VM is configured as follows.

Platform	VMware vSphere
Application	SQL Server
Disk 1 (OS)	60 GB, CBT enabled
Disk 2 (DATA)	400 GB, CBT enabled

The last backup was created at 01:00. Choose the recovery approach that provides the lowest RTO with the least data loss.

- A. Instant VM Recovery with quick rollback
- B. Instant VM Recovery
- C. VM disk recovery with quick rollback of Disk 1
- D. Virtual disk restore of Disk 1

Correct Answer: D

Section:

Explanation:

https://helpcenter.veeam.com/archive/backup/110/vsphere/incremental_restore.html

QUESTION 24

A Veeam proxy server is configured as follows. No modifications are allowed to the transport mode.

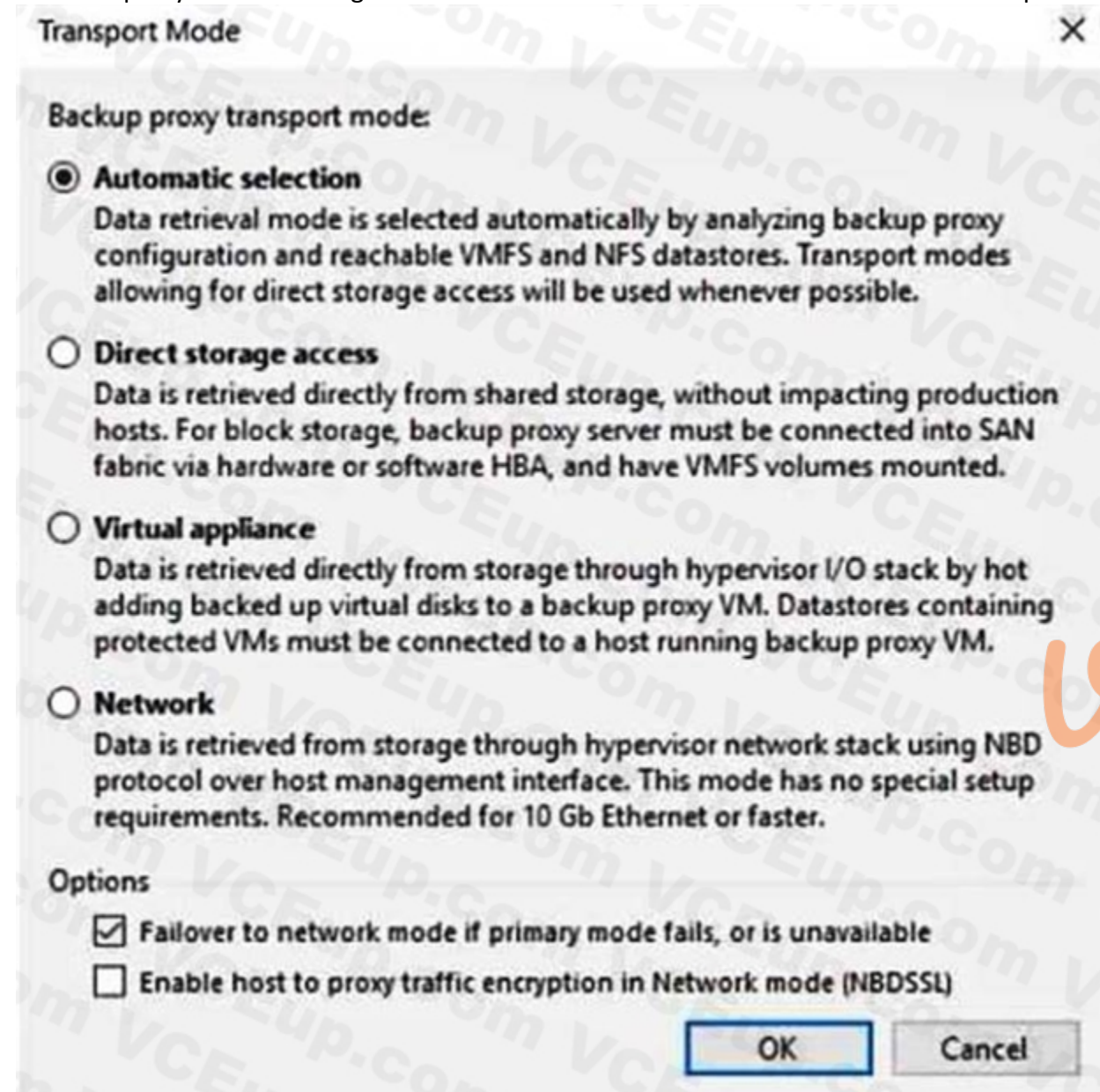

When performing a restore of a thin-provisioned VMware virtual disk on an NFS data store using this proxy server, what transport mode will be used by default?

- A. Direct SAN access
- B. Virtual appliance
- C. Network
- D. Direct NFS access

Correct Answer: B

Section:

Explanation:

Therefore, when restoring a thin-provisioned VMware virtual disk on an NFS datastore using a virtual appliance Veeam proxy server, the transport mode used will be the virtual appliance transport mode.

QUESTION 25

A director has asked for a quarterly report for capacity planning purposes. Which Veeam component should be used?

- A. Veeam Backup & Replication Console
- B. Enterprise Manager
- C. Business View
- D. Veeam ONE Web Client

Correct Answer: D

Section:

QUESTION 26

After performing a failover to a disaster recovery site, it is decided that the VMs need to be failed back to the original production site and that any changes made during the failover should be discarded. Which option should be used?

- A. Undo failover
- B. Undo failback
- C. Failback
- D. Commit failback

Correct Answer: A

Section:

Explanation:

https://helpcenter.veeam.com/docs/backup/vsphere/undo_failover.html?ver=120



QUESTION 27

An infrastructure with 50 VMs has a power outage. After the VMware cluster has booted up again, 10 medium-sized VMs have corrupted VM disk files. Which action can be used to restore the VMs back to the production state?

- A. Use the "Restore guest files" option and restore all VM Files.
- B. Perform Restore VM Files and only restore the VM configuration files.
- C. Perform Restore VM Files and restore the VM configuration and disk files.
- D. Perform Instant VM Recovery with quick rollback.

Correct Answer: B

Section:

Explanation:

By performing a restore of only the VM configuration files, you can quickly recreate the VM in VMware vSphere using the existing disk files on the datastore. This method avoids the need to transfer or copy large VM disk files, resulting in a faster restoration process. Note that this method assumes that the VM disk files are still intact on the datastore. If any of the VM disk files are missing or corrupted, you may need to consider alternative restoration methods or perform a full restore from the Veeam backup files.

QUESTION 28

A customer currently has one backup job that runs every four hours to backup their VMs in a transaction consistent state. Which job configuration will keep all restore points safe in case the primary site and backups go down while still being able to do a point-in-time recovery of a SQL database from the backups on the second site?

- A. Configure a second VM backup job and schedule it to copy every four hours, starting at midnight, to a repository on the second site
- B. Configure a backup copy job in mirror mode, to a repository on the second site
- C. Configure a backup copy job in pruning mode and schedule it to copy every four hours, starting at midnight, to a repository on the second site
- D. Configure a backup copy job in pruning mode and have it copy data every day, starting at midnight, to a repository on the second site

Correct Answer: B

Section:

Explanation:

<https://www.running-system.com/veeam-version-10-favorite-features-immediate-copy-mirroring/>

QUESTION 29

A NAS backup job has been configured within Veeam Backup & Replication, and is completing successfully, but restore operations have been failing for the last few days. What is causing the failure?

- A. The backup repository is sealed
- B. The server was added by using an IQN alias which is unable to be resolved
- C. The credentials added to the share are not allowed read-write access to the share, directories or files
- D. The cache repository assigned for this file share is unavailable for restore operations

Correct Answer: C

Section:

Explanation:

If you must specify user credentials to access the shared folder, select the This share requires access credentials check box. From the Credentials drop-down list, select a credentials record for a user account that has Full Control permissions on the shared folder. To access the SMB share, you must use an account that meets either of the following requirements: If you only plan to back up the share, you can use an account with read-only permissions. If you plan not only to back up the share, but also to restore files to it, use an account with read/write permissions.

https://helpcenter.veeam.com/docs/backup/vsphere/file_share_backup_smb_share_path_credentials.html?ver=110

QUESTION 30

A company needs to recover a domain controller from a backup file they have on premises which was created by the Veeam Agent for Microsoft Windows. Which of the following would provide the fastest access to the domain controller?

- A. Use the Veeam Explorer for Active Directory to recover the domain controller
- B. Perform an Instant VM Recovery to recover the domain controller to a VM on their VMware host
- C. Perform a bare metal recovery of their domain controller back to the original system
- D. Recover the domain controller to an AWS EC2 instance using the restore to Amazon EC2

Correct Answer: B

Section:

Explanation:

Reference: <https://www.veeam.com/blog/how-to-recover-a-domain-controller-best-practices-forad-protection.html>

QUESTION 31

What is the main purpose of the planned failover feature?

- A. Test the VM in a sandbox without impacting the production environment
- B. Proactively switch from running the regular VM to the replica VM
- C. Initiate a disaster recovery procedure when the main site is down
- D. Test a disaster recovery scenario without any downtime on the VM

Correct Answer: B

Section:

Explanation:

Reference: https://helpcenter.veeam.com/docs/backup/vsphere/planned_failover.html?ver=100

QUESTION 32

When you back up regular or standalone VMs in vCloud Director, which of the following is captured and stored in Veeam's Backup & Replication backup file? (Choose three.)

- A. vApp metadata
- B. VM disk content
- C. Raw device mapping
- D. In-guest iSCSI disk
- E. VM metadata
- F. Linked clone VM's prior to vCenter 6.5

Correct Answer: A, B, E

Section:

Explanation:

Reference:

https://helpcenter.veeam.com/docs/backup/vsphere/vcloud_regular_vm_restore.html?ver=100

QUESTION 33

A customer has a physical proxy configured for Direct Storage Access without failover to network mode. The backup fails. What could be the issue?

- A. The disks being processed are IDE and/or SATA
- B. The datastores are properly zoned and exposed to the proxy server but in read-only mode
- C. The storage is not added into the storage infrastructure, inside the backup and replication console
- D. Write access has not been enabled on the SAN
- E. One or more of the VM disk(s) are on Wols

Correct Answer: E

Section:

Explanation:

Reference: https://helpcenter.veeam.com/docs/backup/vsphere/direct_san_access.html?ver=100

QUESTION 34

A company has replicated their critical application VMs to a second data center in another region.

Their key application includes two database VMs and three application VMs. For proper operation, the database VMs need to start before the application VMs. What needs to be configured in Veeam to prepare for a disaster recovery situation?

- A. Use a failover plan
- B. Use a planned failover
- C. Use Instant VM Recovery
- D. Use on-click failover

Correct Answer: A

Section:

Explanation:

Reference: <https://www.veeam.com/virtual-machine-backup-solution-free.html> the course guide veeam say "a presente scenario for one click failover for a group of independent vms, you can set ORDER for the vm's in the plan, and the delay intervals to make sure that some vms are already running at the moment to the dependent vms start"

QUESTION 35

Which of the following statements are true when comparing a synthetic full backup to an active full backup on an NTFS-based backup repository? Choose two options.

- A. If the backup repository performance is weak, creating synthetic full backups is the best choice.
- B. Synthetic full backups consume more network bandwidth.
- C. Synthetic full backups impose less load on the production environment.
- D. In terms of content and retention, the synthetic full backup file is identical to an active full backup file.
- E. Synthetic full backups are always best when launched on a dedupe appliance.
- F. The synthetic full backup file has a .vsb extension, whereas the active full backup has a .vbk extension.

Correct Answer: C, D

Section:

QUESTION 36

Which transport mode uses the VMware vSphere Hot-Add feature to attach the virtual disks of a source VM to the backup proxy VM?

- A. Network
- B. vPower
- C. Virtual Appliance
- D. Direct SAN access
- E. Direct NFS access

Correct Answer: C

Section:

QUESTION 37

When protecting VMs, where is the Veeam CBT driver (file system filter driver) installed?

- A. On every managed Hyper-V 2012 R2 or older host
- B. On every managed Veeam backup proxy
- C. On every managed server
- D. On every managed VMware vSphere ESXi 5.1 or older host
- E. On every managed Hyper-V 2016 or newer host

Correct Answer: A

Section:

QUESTION 38

Which procedure is used to finalize replica failback?

- A. Migrate to production
- B. VMware Storage vMotion
- C. Replica failback does not need to be finalized
- D. Commit failback
- E. Quick Migration

Correct Answer: D



Section:

QUESTION 39

An Availability engineer has configured Veeam Backup & Replication to replicate a mission critical VM to a DR site on an hourly basis and with 24 restore points. The production site has suffered a storage failure and needs to bring up the mission critical machine as soon as possible. Which step should the Availability engineer do next?

- A. Create a failover plan
- B. Failover to the replica VM
- C. Failback of the replica VM
- D. Planned failover to me replica VM

Correct Answer: B

Section:

QUESTION 40

Which of the following need to be performed in order to switch from the original VM to a VM Replica and then to use this replica as the original VM?

- A. Change the replication Job to reverse the replication
- B. Failback + commit failback
- C. Undo failover
- D. Permanent failover

Correct Answer: D

Section:

QUESTION 41

Which of the following can help reduce the amount of traffic that is sent over the network during the second run of a replication job?

- A. Replica seeding
- B. Re-IP rules
- C. Replica mapping
- D. WAN acceleration for replicas

Correct Answer: A

Section:

Explanation:

https://helpcenter.veeam.com/docs/backup/vsphere/replica_seeding.html#:~:text=Replica%20seeding%20and%20mapping%20are,traffic%20sent%20over%20a%20network.

QUESTION 42

Which HPE SAN storage systems are supported by the Backup from Storage Snapshots feature in Veeam Backup & Replication? Choose three options.

- A. HPE StoreVirtual and StoreVirtual VSA
- B. HPE Nimble Storage AF-series and CS-series
- C. HPE StoreEasy Storage
- D. HPE 3PAR StoreServ
- E. HPE StoreOnce



Correct Answer: A, B, D

Section:

QUESTION 43

What is the main advantage of using the Backup from Storage Snapshots feature?

- A. It does not create VMware snapshot(s).
- B. It saves space in the repository.
- C. It speeds up the backup process.
- D. It decreases the amount of time the VM is running on a VMware snapshot.

Correct Answer: D

Section:

Explanation:

The backup process is going to take the same amount of time, but the commit operation of the vmware snapshot has shorter duration when working with storage snapshots

QUESTION 44

What is Veeam vPower NFS Service used for?

- A. It is used to send data to the original location or to a new location specified by the user when restoring it.
- B. It allows Veeam Backup & Replication to present VM files in a native format to an ESXi host, from a compressed and deduplicated backup file.
- C. It is used to mount a compressed and deduplicated backup file directly to the backup server and perform file and item level restore.
- D. It continuously checks the configuration settings of jobs and starts them in accordance with their schedules.

Correct Answer: C

Section:

QUESTION 45

Which of the following should be considered when estimating the amount of disk space necessary to store backups? Choose two options.

- A. Retention period for backups
- B. Type of disk (thick or thin)
- C. Hypervisor and host version
- D. RAID configuration of the Backup Repository
- E. Veeam Backup & Replication edition
- F. Total size of used data for the VMs being backed up

Correct Answer: A, F

Section:

QUESTION 46

Veeam Backup & Replication supports which of the following NetApp Data ONTAP modes?

- A. Only NetApp EDGE in 7-Mode
- B. Clustered Data ONTAP only
- C. Both 7-mode and Clustered Data ONTAP
- D. 7-mode only

Correct Answer: C

Section:

QUESTION 47

Which is a prerequisite in order for the CRC check to be executed during a SureBackup Job?

- A. The .vbm file is corrupt.
- B. The Backup file integrity check option was enabled in the SureBackup job setting.
- C. One or more of the SureBackup recovery verification tests failed.
- D. The repository where the backup is stored is a shared folder (CIFS/SMB).

Correct Answer: B

Section:

QUESTION 48

Which of the following services are installed on every Veeam backup proxy server? Choose two options.

- A. Veeam Installer Service
- B. Veeam Backup Service
- C. Veeam Data Mover Service
- D. Veeam Distribution Service
- E. Veeam Backup Catalog Service

Correct Answer: A, C

Section:

Explanation:

Refer to https://helpcenter.veeam.com/docs/backup/vsphere/backup_proxy.html?ver=100



QUESTION 49

Which is the mount server component used?

- A. When there are multiple backup servers
- B. When backing up to tape at a remote site
- C. When the remote backup repository is a CIFS share
- D. When restoring files or application items with Veeam Explorers

Correct Answer: D

Section:

QUESTION 50

Which recovery verification tests can be executed when verifying both backups and replicas? Choose three options.

- A. Heartbeat test
- B. Ping test
- C. Application test
- D. Memory test
- E. Operating System test

F. CRC check

Correct Answer: A, B, C

Section:

QUESTION 51

The advanced installation scenario requires installing the Veeam ONE Server component (server part) on one machine and installing the Veeam ONE Web UI component (client part) on another machine.

A. True

B. False

Correct Answer: A

Section:

QUESTION 52

Which of the following Veeam Backup & Replication jobs can utilize storage snapshots on VMware vSphere?

Choose two options.

A. Replication

B. Backup copy

C. VeeamZIP

D. Backup

E. Tape

F. VM copy

Correct Answer: A, D

Section:

QUESTION 53

If the deduplication setting are changed for an existing job, when will the new setting be applied?

A. At the next run of the job

B. If any kind of full backup is created

C. If a new active full backup is created

D. Only when you rescan the repository that stores the backup files

Correct Answer: C

Section:

Explanation:

https://helpcenter.veeam.com/archive/backup/95/vsphere/compression_deduplication.html

To apply new deduplication settings in backup jobs, you must create an active full backup after you change deduplication settings. Veeam Backup & Replication will use the new block size for the active full backup and subsequent backup files in the backup chain.

QUESTION 54

What is the purpose of scheduling a virtual Synthesized full backup for tape jobs?

A. To be able to restore files and folders from tape

B. To be able to create the synthetic full .vbk backup directly on tape



- C. To help save additional disk space on tape
- D. To avoid copying a full .vbk file to tape from the source reverse incremental backup Job

Correct Answer: D

Section:

QUESTION 55

A Backup Administrator needs to create a fully functional VM at a secondary location in an isolated network. The VM should not require manual editing or modifications to the configuration. Which of the following jobs could the Backup Administrator use? Choose two options.

- A. SureBackup
- B. VeeamZip
- C. VM Copy
- D. Replication
- E. Backup
- F. Configuration Backup

Correct Answer: C, D

Section:

Explanation:

https://helpcenter.veeam.com/docs/backup/vsphere/about_replication.html?ver=100

https://helpcenter.veeam.com/docs/backup/vsphere/vm_copy.html?ver=100

QUESTION 56

Staged Restore is available for which type of restore mode?

- A. File-Level Restore
- B. Virtual Disk Restore
- C. Object-Level Restore
- D. Full VM Restore

Correct Answer: D

Section:

QUESTION 57

Offloading backup files to the capacity tier of a scale out repository can be done automatically by leveraging what type of job?

- A. Archive Job
- B. Offload Job
- C. Backup Copy Job
- D. Backup Job

Correct Answer: D

Section:

QUESTION 58

Which backup method will always produce a full backup as the most recent restore point?



- A. Forever forward incremental backup
- B. Forward incremental backup
- C. Reverse incremental backup
- D. Forward incremental with transform

Correct Answer: C

Section:

QUESTION 59

Which of the following statements regarding bottleneck statistics is true?

- A. The percentages displayed will always add up to 100% in total.
- B. The bottleneck statistics are only displayed when you have a problem in your backup infrastructure.
- C. Bottleneck statistics can show the following states: Source/Proxy/Network/Source WAN Accelerator/Target WAN Accelerator/Target/None
- D. Bottleneck statistics can show the following states: Source/Ptoxy/Network/Source WAN Accelerator/Target WAN Accelerator/Target

Correct Answer: A

Section:

QUESTION 60

Sometimes snapshots are "lost" by vCenter. What tool finds and removes those lost snapshots?

- A. CLI Snapshot Removal Tool
- B. Snapshot Hunter
- C. Snapshot Extractor
- D. Veeam ONE Orphaned VM Reporter



Correct Answer: B

Section:

QUESTION 61

Which of the following statements is true regarding the Veeam Backup & Replication integration with supported Storage Systems for VMware vSphere are true? (Choose three).

- A. On storage accesses through NFS, VMs with snapshots will be skipped from Backup from Storage Snapshots
- B. Veeam Backup & Replication can backup virtual machines from a supported secondary storage array
- C. On storage accessed through NFS, VMs with snapshots can be protected with Backup from Storage Snapshots
- D. When Backup from Storage Snapshots is performed, VMware snapshot is never utilized
- E. Enabling Backup from Storage Snapshots for all backup jobs are not recommended

Correct Answer: A, B, E

Section:

QUESTION 62

Which of the following Veeam Backup & Replication jobs can use integration with secondary arrays as a data source?

- A. Backup

- B. VM copy
- C. Replication
- D. Tape backup

Correct Answer: A

Section:

QUESTION 63

A scale-out backup repository is configured with data locality policy. How is an extent selected during an active full backup? (Choose two.)

- A. Always the same extent as the previous full backup
- B. An extent determined based on load control settings and free space
- C. A different extent from the previous chain to avoid single point of failure, if possible on free space
- D. It tries the same location as the previous full if using a deduplication appliance

Correct Answer: B, D

Section:

QUESTION 64

Which of the following actions generated the data recommended when raising a technical support case regarding a failed Veeam Backup & Replication job?

- A. Export the license file from the configuration options in Enterprise Manager
- B. Generate a zip of log files using the Support Information function
- C. Take a Veeam Zip of the VMs involved in the failed job
- D. Manually run a Veeam configuration backup to generate a new .bco file



Correct Answer: B

Section:

QUESTION 65

You want to deploy an On-Demand Sandbox. While creating the application group, which sources can be used to add virtual machines to the Application Group? (Choose three.)

- A. Backup Copy in Backup repository
- B. Replica on non-Cloud Connect VMware vSphere host
- C. Replica on Cloud Connect VMware vSphere host
- D. Backup in Cloud Repository
- E. Storage Snapshot
- F. Backup on Backup Repository

Correct Answer: B, E, F

Section:

QUESTION 66

Which of the following statements regarding the Backup from Storage Snapshots feature when backing up virtual machines from a VMware vSphere environment are true? (Choose two.)

- A. Lower impact on WAN link during off-site backups
- B. Higher transfer speed from production NFS datastores

- C. A virtual machine with one virtual drive on shared storage and another drive on local storage will be processed with Backup from Storage Snapshots transport mode
- D. A virtual machine with one virtual drive on shared storage and another drive on local storage will failover to a different transport mode
- E. Reduce the impact of consolidating VM snapshots

Correct Answer: B, E

Section:

Explanation:

QUESTION 67

Backup jobs are configured to local repositories. Backups must be sent from Site B to the repository on Site A. The connection allows direct backups to complete within the backup window. Impact on the source VMs at Site B should be minimized. Which type of job and Veeam components should be used to provide the necessary protection?

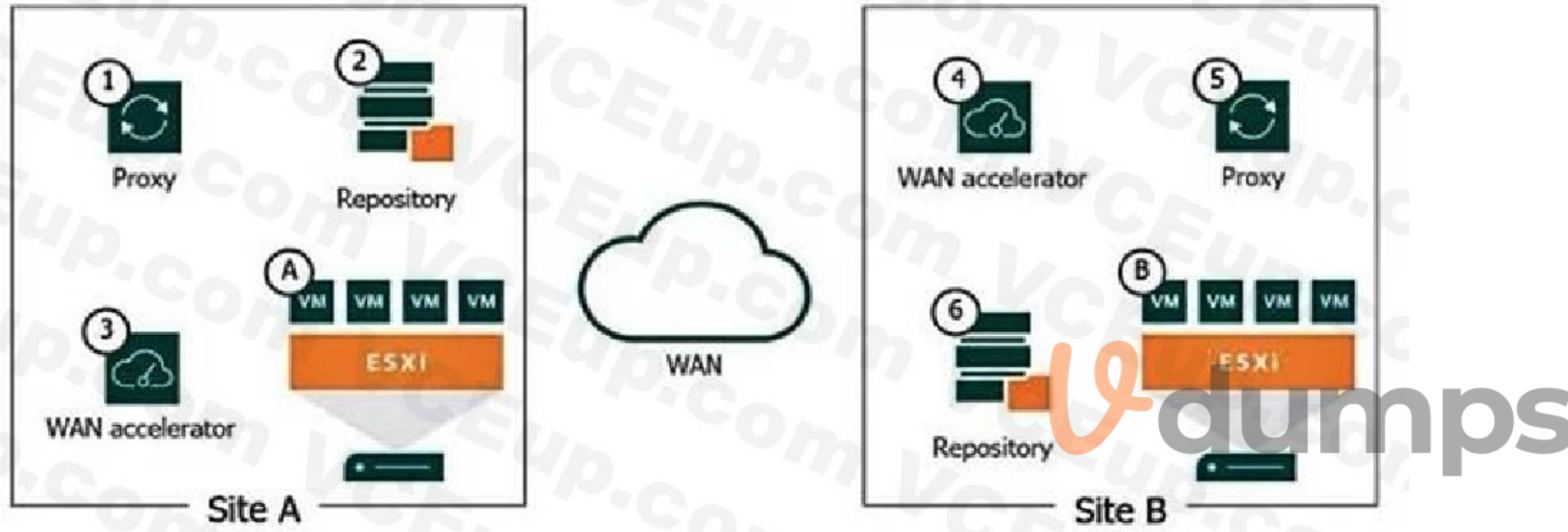

- A. A backup copy job and components 6 → 5 → 4 → 3 → 2
- B. A backup job and components 5 → 2
- C. A backup copy job and components 6 → 2
- D. A backup copy job and components 6 → 4 → 2

Correct Answer: A

Section:

Explanation:

Explanation:
https://helpcenter.veeam.com/docs/backup/vsphere/backup_copy_path.html?ver=120

QUESTION 68

An administrator needs to create a strategy in advance of a disaster to ensure the applications can be started in a specific order. How can this be accomplished?

- A. Failover plan
- B. Attach XML file to existing job with the VM start order
- C. Application group

D. Veeam One migration script

Correct Answer: A

Section:

QUESTION 69

It is required that some replicated VMs start on a time delay during a failover. How can this be accomplished?

- A. Modify the failover template file.
- B. Create a failover plan.
- C. Use a pre-freeze/post-thaw script
- D. Adjust boot delay in application group.

Correct Answer: B

Section:

QUESTION 70

In Veeam Enterprise Manager, what granular restoration permission can be set for the Restore Operator role?

- A. SharePoint items
- B. File items
- C. Active Directory items
- D. OneDrive items

Correct Answer: B

Section:

Explanation:

The granular restoration permission that can be set for the Restore Operator role in Veeam Enterprise Manager is File items. This permission allows the restore operator to recover files and folders from the backup of any machine in their restore scope. The restore operator can also specify the file types that they want to recover, such as documents, images, videos, and so on¹. The other options are not valid for the Restore Operator role, as they are related to application items that can only be restored by the Portal User role with appropriate delegation settings². For more information on the Restore Operator role and its permissions, see [Accounts and Roles Overview](#) in the Veeam Backup Enterprise Manager Guide.

QUESTION 71

An administrator is reviewing backup jobs and notices that backups of VMware VMs that are located on a SAN are taking longer than normal to back up. What could be a cause of this?

- A. The backup proxy in use is failing over to Virtual Appliance mode.
- B. The guest interaction proxy is failing over to data access mode.
- C. The backup proxy in use is failing over to Network mode.
- D. The backup repository needs to be changed to a Scale-out Backup Repository.

Correct Answer: C

Section:

Explanation:

When the backup proxy fails over to Network mode, it can impact the backup performance, especially for VMs located on a SAN. In Network mode, the backup traffic is transferred over the network rather than utilizing direct SAN access or VMware vStorage APIs for Data Protection (VADP). This can result in increased backup times due to the additional network overhead and slower data transfer rates.

QUESTION 72

Why is it recommended to have at least one backup proxy server in each site when defining a replica Job?



- A. The proxies allow automatic WAN acceleration.
- B. The proxies allow for no VM snapshots during transit.
- C. The proxies allow replication automatic restart after failure.
- D. The proxies enable a stable connection for VM data transfer across sites.

Correct Answer: A

Section:

QUESTION 73

A domain administrator is working on a PowerShell script. Due to an error, the script drops 40 users out of 100 from the Business Management Organization Unit in Active Directory. Veeam Explorer for Active Directory will be used to restore it back. Choose the option that will restore functionality with the minimum impact on user experience.

- A. Use the 'Quick Rollback' option to perform a restore of the changed blocks of the Active Directory database file.
- B. Use the 'Fine-tune' restore option to roll back the Organizational Unit to the correct state.
- C. Use the 'Point in Time' option to specify the point in time you want to restore the Active Directory database to.
- D. Use the 'Compare with Production' option to restore only the missing objects back to the Organizational Unit.

Correct Answer: A

Section:

QUESTION 74

25 VMs are running on a VMware platform at a remote office (ROBO). The administrator has been tasked with setting up replication to the main office (HQ) so it can act as the disaster recovery site. The available bandwidth is 50 Mbps. RPO is set to four hours and the data generated for the interval is 150 GB. Which of the following will achieve the RPO?

- A. Use replication jobs with copy mode set to 'interval copy'. Schedule to run every four hours.
- B. Configure the replication jobs with traffic throttling to 30 Mbps to limit the impact. Schedule to run every four hours.
- C. Use replication jobs with copy mode set to 'periodic copy' and copy every four hours.
- D. Configure the replication jobs with WAN acceleration enabled. Set the schedule to run every four hours.

Correct Answer: D

Section:

QUESTION 75

Which of the following Veeam Backup Agents can perform bare metal restores? (Choose 2)

- A. Veeam Agent for Linux
- B. Veeam Agent for IBM AIX
- C. Veeam Agent for Mac
- D. Veeam Agent for Oracle Solaris
- E. Veeam Agent for Microsoft Windows

Correct Answer: A, E

Section:

QUESTION 76

An undo failover of a VM has just completed, after having failed over earlier from production to the disaster recovery site. What next actions are available?

- A. Fallback, Permanent Failover
- B. Failover, Fallback to production. Add to a failover plan
- C. Failover now, Planned failover, Add to failover plan
- D. Failover, Planned failover, Run a failover plan

Correct Answer: D

Section:

QUESTION 77

An Infrastructure with 50 VMs has Issues with the underlying storage. 10 large VMs show the error 'NVRAM write failure. Which restore method will bring back those VMs to the production state?

- A. Use the 'Restore guest files' option to restore the NVRAM and VM disk files.
- B. Perform Instant VM Recovery with the option 'NVRAM-only' enabled.
- C. Use Restore VM Files and restore the NVRAM file.
- D. Perform Instant VM Recovery with quick rollback with automatic Power On VM at the end.

Correct Answer: C

Section:

QUESTION 78

To view current information about the entire Veeam backup Infrastructure, including alarms and the status of jobs, use Veeam ONE'S_____.

- A. Data Protection View
- B. Business View
- C. Enterprise View
- D. Report View

Correct Answer: A

Section:

QUESTION 79

An administrator Is asked to change a backup copy Job from periodic mode to immediate mode. How can this be accomplished?

- A. Right click on the job name and choose immediate.
- B. Enable immediate in the backup copy job settings drop down.
- C. Copy the original backup copy job to a different folder and remap the job.
- D. Create a new backup copy job and delete the original job.

Correct Answer: D

Section:

Explanation:

https://helpcenter.veeam.com/archive/backup/110/vsphere/backup_copy_modes.html

QUESTION 80

The configuration database is corrupted, and the backup administrator wants to recover the dat a. Which configuration restore mode should be used?



- A. Restore
- B. Instant Recovery
- C. Failover
- D. Migrate

Correct Answer: A

Section:

Explanation:

The Restore mode in the VMware Configuration Restore wizard restores the configuration database from a backup. This mode is typically used when the configuration database has become corrupted or damaged.

QUESTION 81

A VMware vSphere Windows VM is protected using the file Indexing option. Which of the following Veeam components can be used to deploy the runtime during the backup process?

- A. virtual lab
- B. Indexing database server
- C. Guest Interaction proxy
- D. File proxy

Correct Answer: C

Section:

QUESTION 82

An infrastructure with 50 VMs has a power outage. After the VMware cluster has booted up again, 10 large VMs are orphaned. However, all VM disk files are still on the datastores. What is the quickest way to bring back those VMs with the least possible data loss?

- A. Use the 'Restore guest files' option to restore the VM configuration files.
- B. Perform Restore VM Files and only restore the VM configuration files.
- C. Remove the existing VM disk files from the datastore and perform Instant VM Recovery.
- D. Perform Instant VM Recovery with quick rollback with automatic Power On VM at the end.

Correct Answer: B

Section:

Explanation:

By performing a restore of only the VM configuration files, you can quickly recreate the VM in VMware vSphere using the existing disk files on the datastore. This method avoids the need to transfer or copy large VM disk files, resulting in a faster restoration process. Note that this method assumes that the VM disk files are still intact on the datastore. If any of the VM disk files are missing or corrupted, you may need to consider alternative restoration methods or perform a full restore from the Veeam backup files.

QUESTION 83

A backup administrator must enable guest file system Indexing for a backup job of a Microsoft Windows file server VM. All required credentials are added to the Veeam Backup & Replication server. VMware tools (VIX) are installed and up to date on the VM. What should be done to make it possible in the following environment?

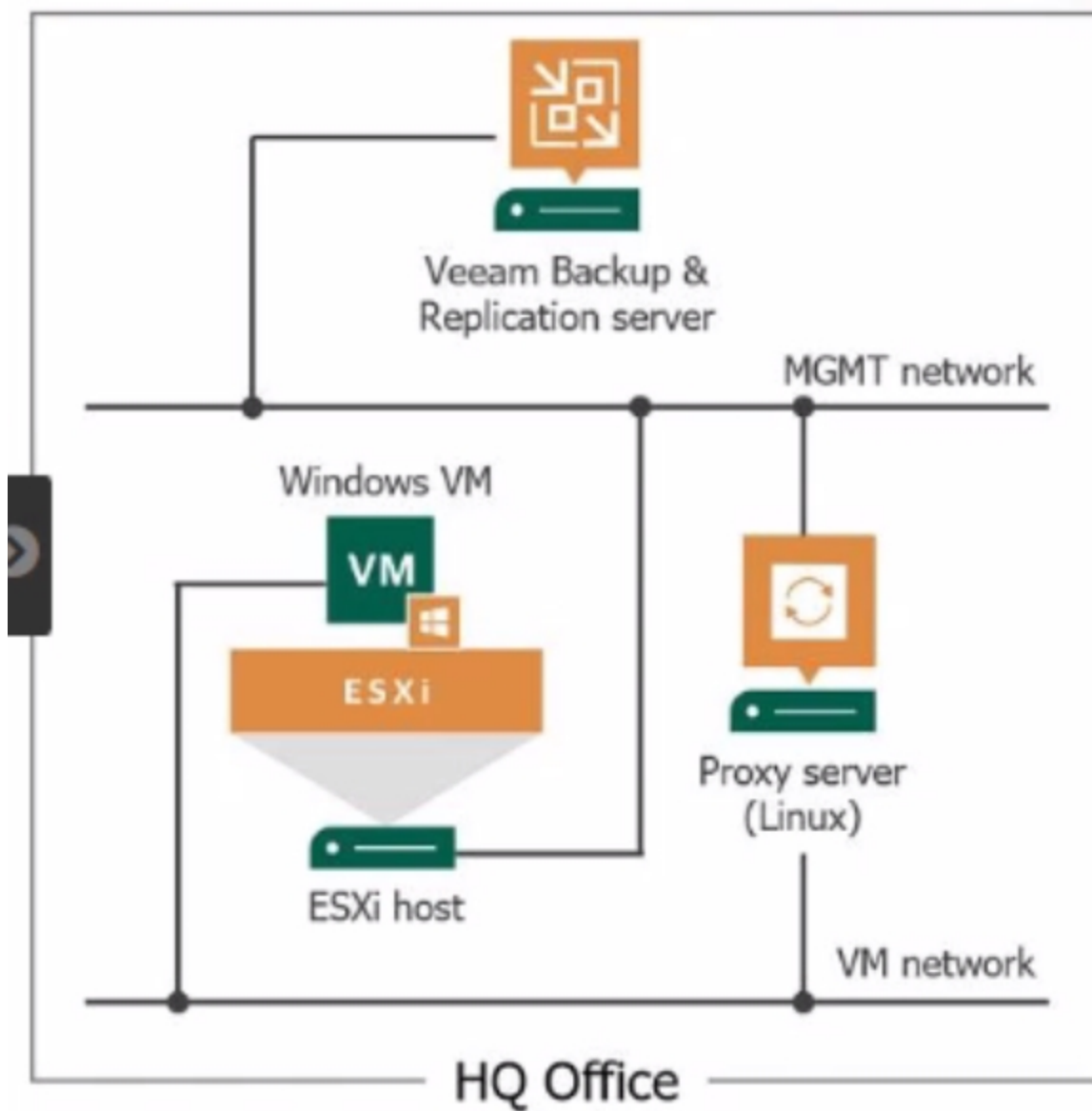

 Vdumps

- A. Use the Linux proxy server as a guest interaction proxy.
- B. Install a file system Indexing plugin on the Microsoft Windows file server.
- C. Connect the ESXi host to the VM network.
- D. Use the Veeam Backup & Replication server as a guest interaction proxy.

Correct Answer: A

Section:

QUESTION 84

Veeam ONE has been Installed and configured. The administrator needs to monitor the VMware datastore capacity. Where can this information be found?

- A. Under Infrastructure View, select all VMs to calculate the remaining datastore disk space.
- B. Under Business View, select Hosts to see each datastore and its disk space.
- C. Under Infrastructure View, select the Datastores group and view the disk space.
- D. Under Business View, select VMs to see the total amount of used disk space.

Correct Answer: C

Section:

Explanation:

https://helpcenter.veeam.com/archive/one/110/monitor/vsphere_datastore_summary.html

QUESTION 85

The administrator of a VMware environment backed up by Veeam Backup & Replication has a critical server that has crashed and will not reboot. They were able to bring it back online quickly using Instant VM Recovery so people could continue to work. What else is required to complete the recovery?

- A. Commit failover
- B. Merge delta file
- C. Migrate to production
- D. Commit fallback

Correct Answer: C

Section:

Explanation:

https://helpcenter.veeam.com/docs/backup/vsphere/instant_recovery_review_vm.html?ver=120

